

State of S. Carolina Pursuant to 193
 a warrant from John Thomas Esq. Clk. N. of Saluda. Dated the
 15. Dec. 1786. I have admeasured &
 laid out unto John Priester a tract
 of One Hundred & Eleven Acres of land
 Situate on the waters of Camping Creek
 a branch of Saluda River and hath such
 shape from Marks Buttings & Boundings as the
 above plat Represents Surveyed the 23rd Dec. 1786. Tho. Waters Esq.
 Recorded 4th April 1787. Dea. Aaron Appick

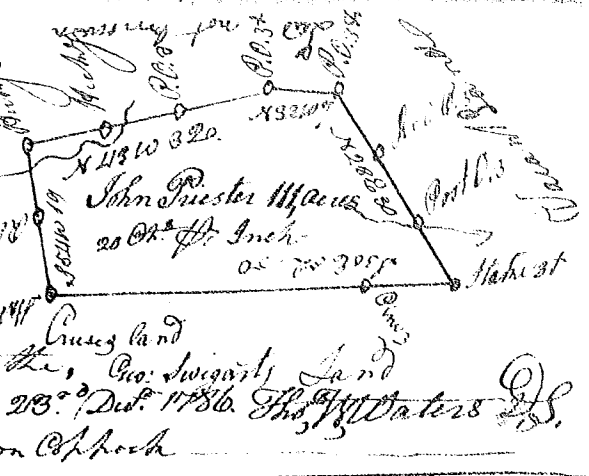

State of S. Carolina Pursuant to a warrant from
 John Thomas Esq. Clk. N. of Saluda Dated the
 5. Jan'y 1787. I have admeasured & laid
 out unto Henry Dominick a tract
 of One Hundred Acres of land Situate
 on the waters of Butler Creek a branch
 of Saluda River hath such shape and
 marks as the above plat Represents
 Surveyed the 17th Feb'y 1787
 Recorded 4th April 1787. Tho. Waters Esq.



State of S. Carolina
 Pursuant to a warrant
 from John Thomas
 Esq. Clk. N. of Saluda
 Dated the 5 Jan'y 1787
 I have admeasured
 and laid out unto
 John Lewis a tract
 of 154 Acres of land
 Situate on the waters
 of Beaver Dam a branch
 of Saluda & hath such form marks
 Buttings & Boundings as the above plat Represents
 Surveyed the 27th Jan'y 1787

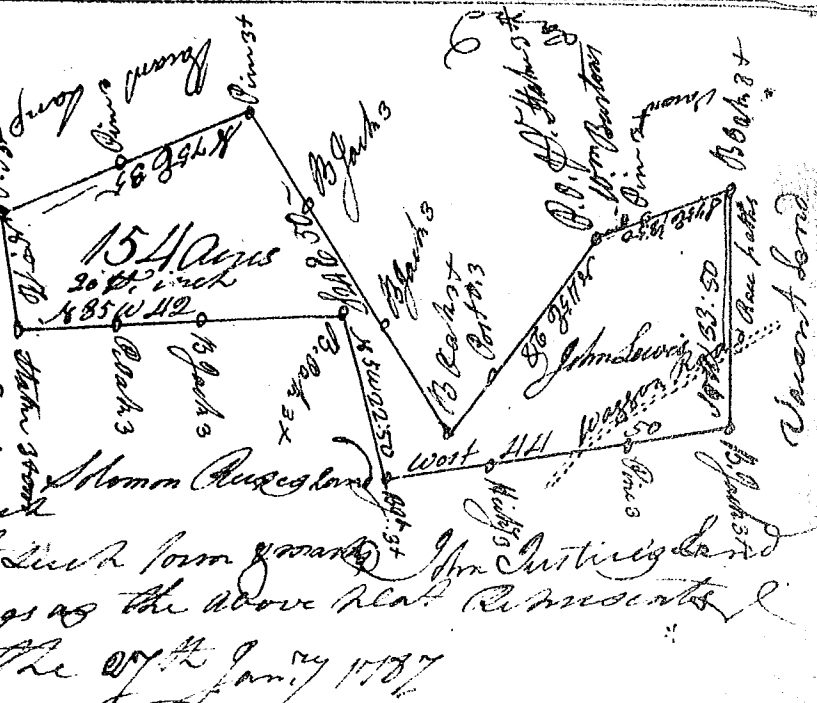

Recorded the 11th April 1787. Tho. Waters Esq.
 Dea. Aaron Appick